

Before Use

1. Completely read and understand these instructions before using the gas stove. We recommend setting it up and testing it so you know how to use it before venturing out.
2. The gas stove is designed for outdoor use only. If you use the gas stove in an unventilated area or tent, you will encounter the risk of carbon monoxide poisoning.
3. Check for leaks before lighting up the gas stove. Do not use the gas stove with fuel leakage.

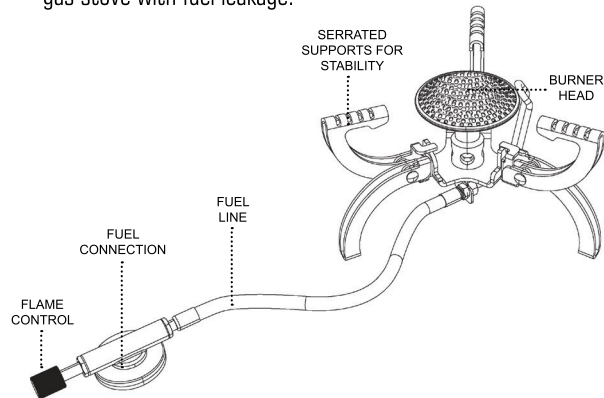

How to Use

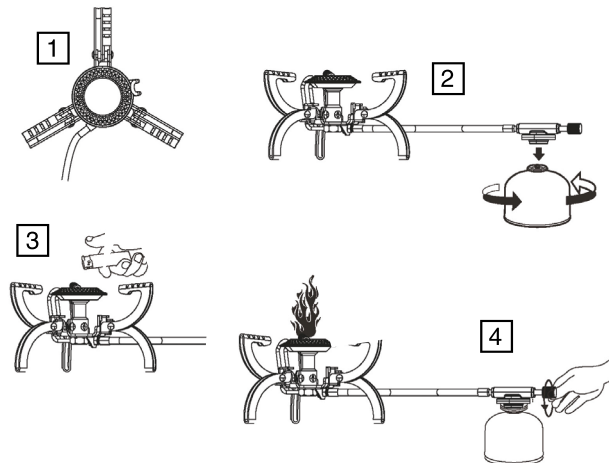

1. Extend the legs and supports outward into position.
2. Connect the propane or butane canister to the connector and turn the fuel on.
3. Light the burner head.
4. Use the flame control to adjust the flame to the desired height.

WARNING

- ▶ Never use this stove in an enclosed space such as a tent, car, camper, garage or home. The stove can produce carbon dioxide which has no odor and may cause death.
- ▶ Never place flammable items on or near the stove while in use. Keep a minimum distance of 3 feet from flammable objects.
- ▶ Never leave a burning or hot stove unattended.
- ▶ Do not move a burning or hot stove.
- ▶ The flame emits 3000W / 8700BTU of heat and can cause severe injury. Keep your head and body away from the top of the flame.
- ▶ Do not place or operate two or more stoves together.
- ▶ Do not over tighten the fuel canister to stove. Over tightening can cause damage and/or a fuel leak.
- ▶ Always check for fuel leaks before and after lighting stove.
- ▶ Never leave a burning or hot stove unattended.
- ▶ Keep children away from stove and fuel.
- ▶ Wait until the stove is completely cooled before putting into case.
- ▶ Always disconnect the stove from canister before storing it.
- ▶ Always store fuel canisters in a well ventilated location away from any type of heat or ignition source ie. water heaters, stoves, pilot lights, furnaces, etc.



**READ
UNDERSTAND
AND
FOLLOW
these
instructions
and warnings
BEFORE
using the stove.**

**You are
responsible
for your own
safety and those
around you.**

NDUR®

**FOLDABLE
MINI-STOVE**
Item #22300

**INSTRUCTIONS
AND
WARNINGS**



www.ndurusa.com

⚠ DANGER ⚠



CARBON MONOXIDE POISONING

The stove is for **OUTDOOR USE ONLY**. Never use inside of a tent, car, house or any type of enclosed area.

- ▶ This stove produces carbon monoxide, which has no odor.
- ▶ Using it in an enclosed space can kill you.
- ▶ NEVER use in an enclosed space. Use in a well ventilated area.



FLAMMABLE

This stove can easily ignite combustible materials, flammable liquids or vapors. Keep stove and canister away from other heat sources. Keep children away from the stove and cooking area, and supervise them at all times. If you smell gas:

- ▶ Do not attempt to light stove
- ▶ Extinguish any open flame
- ▶ Disconnect from fuel canister



EXPLOSION HAZARD

There are potential serious hazards when using this stove and fuel. Accidental fire, explosion, and misuse can cause death, serious burns, and property damage. This stove can easily ignite combustible materials, flammable liquids or vapors.

NDUR® products are
exclusively distributed by:

PROFORCE EQUIPMENT, INC.
3230 Executive Way - Miramar, FL 33025
Ph: 305.436.7984/800.259.5962

www.proforceequipment.com